

Station Parade, Hounslow Road, Feltham

The Ordnance Survey map of 1864 indicates a small row of dwellings adjacent what was to become Feltham Park - it is felt that these [dwellings] must have been erected sometime after 1802; given the fact that that area of Feltham was common land or part of Hounslow Heath pre that date. The parish of Feltham was enclosed in 1802 and much land that was once termed as Feltham Common, 'heath or rough land' was set out in parcels and offered for purchase or auction. The area where Station Parade' now stands was given, for ease of identification 'Parcel W' and within our particularly quarry parcels nr 47 and nr 48

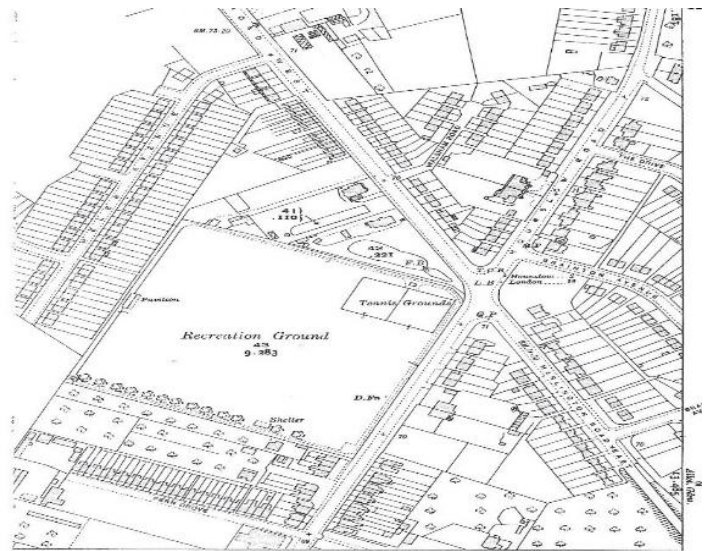
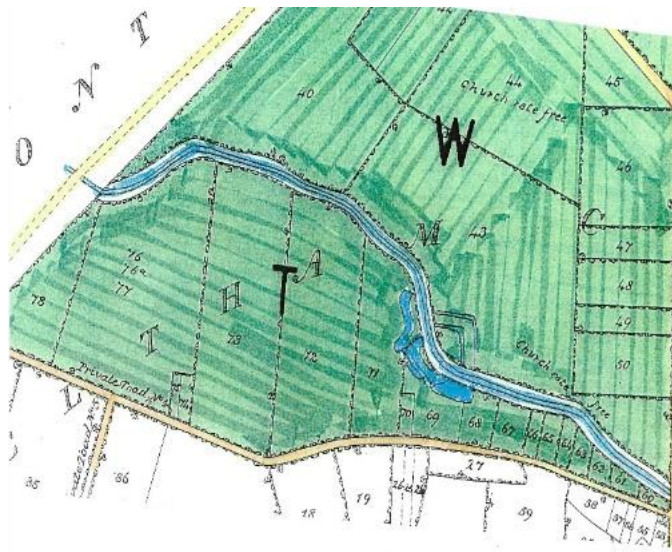

To orientate left of map is Staines Road 'yellow' and 'blue wavy line is the Longford River and Hounslow Road, although not shown, is right of the map.

Parcel 47 was, under the Enclosure, allotted to one John Shirres – details pertaining to John Shirres is scant in the extreme save the fact that he acquired 'freehold' a much larger parcel somewhat north of parcel 47.

Parcel 48 was acquired by Mrs Sarah Redford and held 'copyhold' - Mrs Redford appears to have been fairly wealthy as she had other land mainly around or near to the church of St Dunstan's Feltham Village where an estate of houses is now erected and the road named after her 'Redford Close'

As said the Ordnance Survey map of 1864 shows a small cluster of buildings/dwellings on the southside of what was to become Feltham Park and as most of the land acquired at that time [1802] was mainly used as small market gardens or farms it can only be projected that the buildings were built not long following the enclosure! It would appear that the "cluster" fronting Hounslow Road with the land to the rear were used as small market garden, this same area

was sold by Mr Fear to Feltham Urban District Council as a council nursery upon which a number of large greenhouses were erected,(you may remember them) they remaining so until the late 1960's. Harry acquired the area mid 1870's he being a corn chandler and feed merchant who also traded in fuel and garden fertiliser and general ironmongery from his premises 5 High Street – he also had premises in Staines [Kingston Road] which today still display his name.



Regarding the dwellings we find from the Middlesex Chronicle 4/2/1899 “death of local farmer” Councillor Edward Baker of Fern Villas he being buried at Feltham cemetery in the ‘non conformist section’ there is also a Conveyance concerning Mr James Barnham to Mr. Edwin Barnham dated 1877 ACC/0869/096 for Land & three cottages on the Hounslow Road in Feltham village. A Counterpart Lease (for 7 years) further evidences Mr. B.C. Engall to Mr. Jas. Powell. 1870 ACC/0869/097 The purpose of the afore-going detail is to provide a date to the building of the houses along Hounslow Road which became Station Parade.

The houses, therefore, of today's Station Parade were originally built as homes sometime in the 1880's, as can be seen in this image circa 1900 – however by about the 1930's some of the houses became what are termed as ‘parlour shops’ as detailed in Kelly's ‘business’ Directories of that time



This image 'c1900' shows a more tranquil time; the Nun 'left of image' in the habit and wimple may well have walked from St Theresa's Convent at Hatton. Note old Fern Grove road sign near to where children are 'huddled' on the corner

In the government commissioned land and buildings evaluations of 1909/13 the houses named Fern Villas were consecutively numbered 1, 2, 3, 4 with the following block of houses called Engalls Cottages numbered 1, 2, 3 they were named after the owner/builder John Engal. They were of a later build and were set back by some ten feet from Fern Villas. The third block of houses/shops were possibly built in the mid 1920's and were, in the 1930's numbered 19, 21, 23, 25

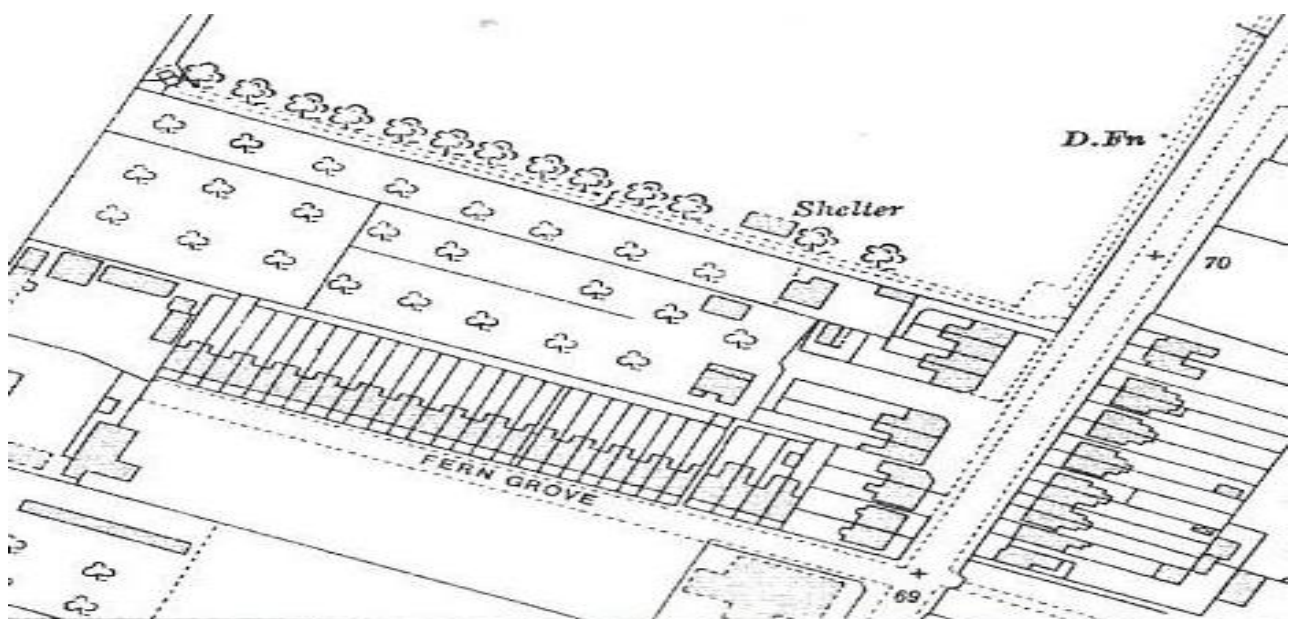

The following information is taken from Kelly's Directory and it would appear that the houses/business's had undergone a re-numbering.

Kelly's did not always state all numbered outlets/businesses but the following are from the early 1930's – at 11 Station Parade was Bailey and Williams 'butchers' – at nr 15 was Edwards Chemist which became Moss Chemist.

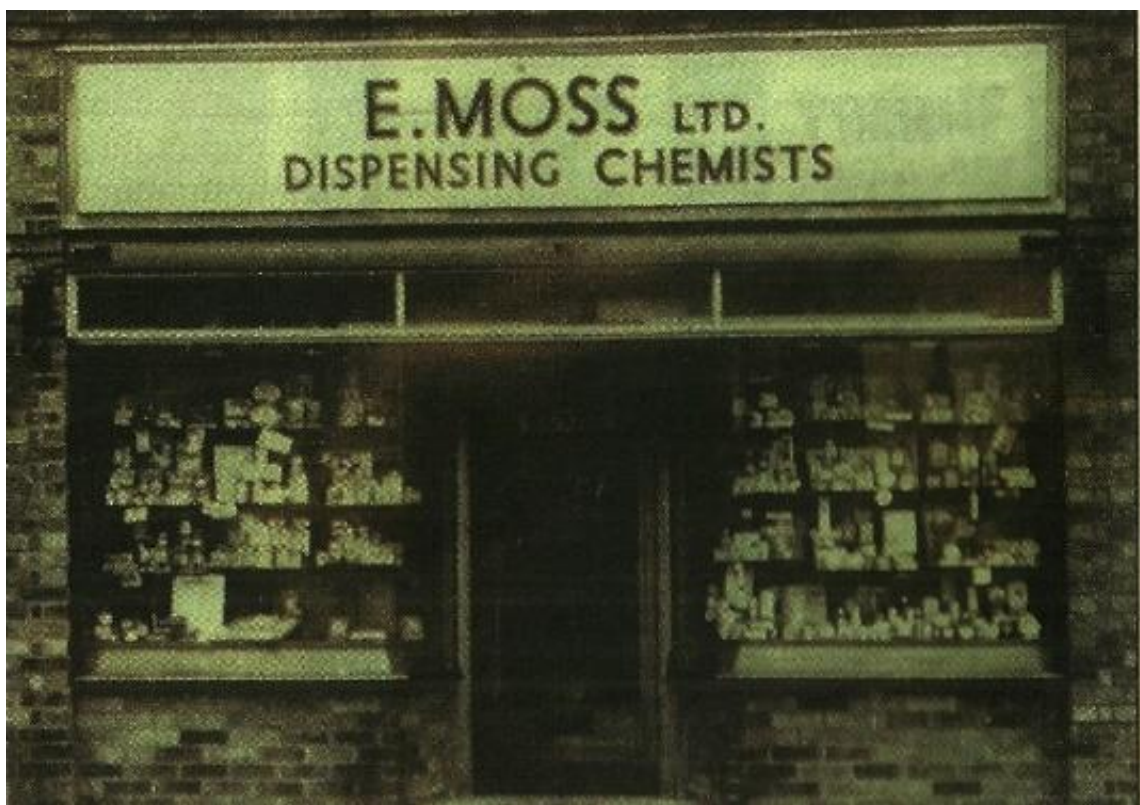

This is an image of a similar store in Feltham High Street

At 19, was Wilfred Clinton (1937) 'Baker' at 21 was John William Dredge a beer retailer at 23 Harold Abbott (snr) (1937) news agent confectioner travel agent, at 25 a Radio and Electrical store 'no name' with at the end shop, nr 29 Crossley's Fishmongers later became Broadway Fisheries 'fish and chips' – the proprietors were the Crossley family and in particular son Geoff.



In this image Mr Abbott can be seen with his two sons in front of generous window adverts and free standing street adverts which projected parallel onto the forecourt. 'note reference to Ashford Astoria'

The following information is post war and mainly 1950/60' (information from Les Gamble) beginning with nr 9 Youth employment bureau which became a Bookmakers, Mr Songi/Ladbrokes and now a small licenced café, nr 11 Baileys 'butchers and grocery' the Bailey sons went on to run public houses. The Airman being one. Nr 13 Happicraft toys et cetera – nr 15 Edwards 'Chemist', nr 17 a 'dry cleaners' nr 19 Gilliam 'green grocer' – nr 21 Camel Off-licence, nr 23 Abbotts news agent/ sweet shop and travel agent, then an 'electric shop' followed by Marcus Thompson iron monger and finally nr 29 Crossleys 'Broadway Fisheries'. In this image Broadway Fisheries – on the right - is no longer 'Geogh's place' but Eastern ?promise?



The Gamble family have lived opposite since the 1930's and Miss Beryl Gamble has various cine film of the period and we (Feltham History Group) are hoping to have them converted into a more modern medium which we hope to donate the local studies section of Feltham Library.

Below are business's of today set out along Station Parade



Alan Rice
Hon Secretary
Feltham History Group