

Feltham History Group

November 2014 meeting
held at Christ Church Hanworth Road Feltham (Ruffle Room)

The Chairman welcomed members to the November meeting of the group opening with an account of the group's participation in Hounslow's Tree planting project which is to be rolled out throughout the Borough; Feltham Pond Green being one of the many areas chosen. The history group's own planting was of a Red Oak.

The Chairman continued on the theme of trees with an invitation to help dress a Christmas tree, this is a special project initiated by members of Christ Church Feltham. The History group are supporting this project by entering their very own tree. Viewing of the trees is from Friday 12th for 4 days

The Chairman continued with a request from Hounslow Council for volunteers to be trained in surveying listed buildings and structures. Three members of the group indicated an interest in this as a way of showing commitment to Feltham's few and ever dwindling buildings of old

The Secretary informed members of an e-mail received concerning a 'Lost Road' from an Andy Thompson

The correspondent enquired about what he and a friend referred to as lost road

"My friend lived in Hereford Road from 1975 to 2004 but [she] knows nothing about this missing road - even though it ran directly at the end of that road and she went to the school that's in the same field as the missing road during the early 1980s.

He describes it further but so as not to repeat or duplicate the enquiry the following was provided,

Before 1800, i.e. that is before the Enclosure Act of that time there was a road from Hounslow [Barracks] to Feltham that ran roughly on the line indicated by Andy's. However the old road was not included in the post enclosure Map of Feltham.

In 1770 'It is understood' that a certain Mr Burgoyne, who was acquainted with the London Volunteers, walked from the encampment on the Heath to Feltham; the rural quietness [of the place Feltham] so impressed him that he acquired several properties and had a house built. One of which was The Grange which was 'demolished' early 1950's.

Burgoyne's 'walk' from Hounslow [on the old road] would have been via Feltham Bridge 'not the High Street Bridge' but one that crossed the Crane River at or where the 40 Acre/Cavalry tunnel is today,

However, and although the line of his lost road seems to follow the pre 1800 road, it is more likely to have a more modern explanation.

In the Kempton (Sunbury) Water Works there is a map set 'high up on the wall and is circa early 20 Century.

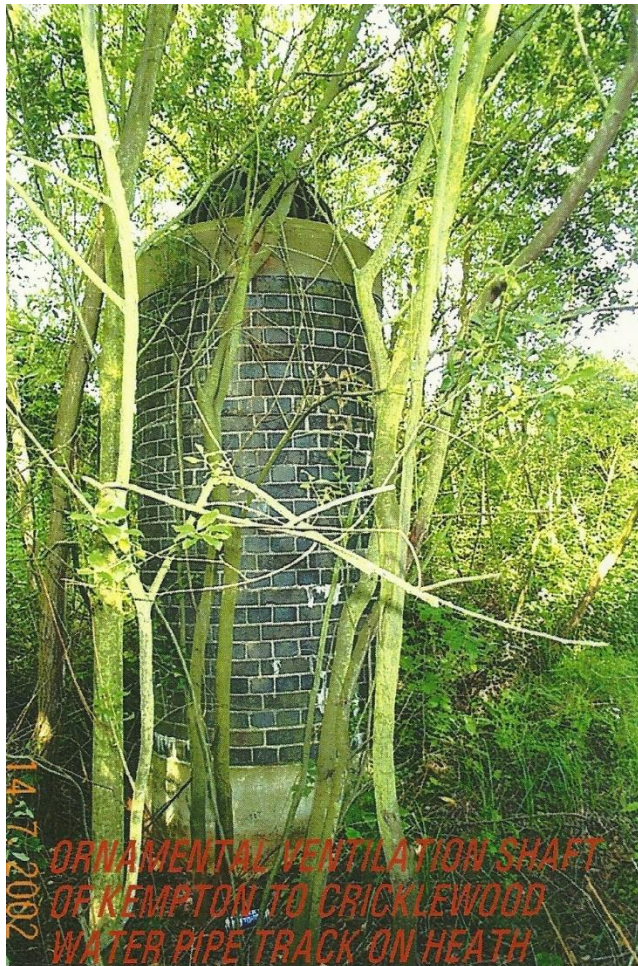

The map describes 'or plots' the line of a Pipe Track from Kempton to Cricklewood Water Works. The pipe is for the conveyance of water.

The track is indicated on Ordnance Survey Maps by the word(s) 'posts' If we concentrate on the O/S maps (1914, 1920, 1934 etc) we can trace the line from the Barracks to Feltham.

At certain points along the track there are DEEP 'inspection' chambers 'railed off areas'.

The first [on this map] of which is at the north end of Corporation Avenue, - that is the reason why Corporation Avenue is so wide.

Coming south, and near to what was Parke Davis chemical and pharmaceutical works, is a railed area similar is evidenced near to the two bridges on the heath and before you enter Sparrow Farm Drive there is a Valve House/Pumping Station.

Another mystery [to some] is the long and wide strip of land that cuts through Sparrow Farm and Cygnet Avenue 'to the rear the houses' this is the line of the pipe track; it then continues onward under the Railway Line showing itself again near De-Brome School buildings [as noted by Andy] and then across what is today known as De-Brome Open Space [Leitrim Park] towards Uxbridge Road - at Uxbridge Road is another railed off area – which was once a small Allotment 'gardened' by the Pearce Brothers (Bill and Bob) of Hereford Road, here there is another inspection chamber.

Crossing the Uxbridge Road it journeys across the northern section of Hanworth [great] Park and the parish boundary of Hanworth and Feltham.

Near Forest Road it is set below the Longford River before continuing along the strip of land to the south of Forest Road and after it crosses Elmwood Avenue another Pumping Station can be viewed.

From here the line is further evidenced by railings until its place of emanation is reached 'Kempton Water Works'.

Mingled in the midst of imagination and time there was another option I gave Andy and that was that just west of the De-Brome gates was once a short

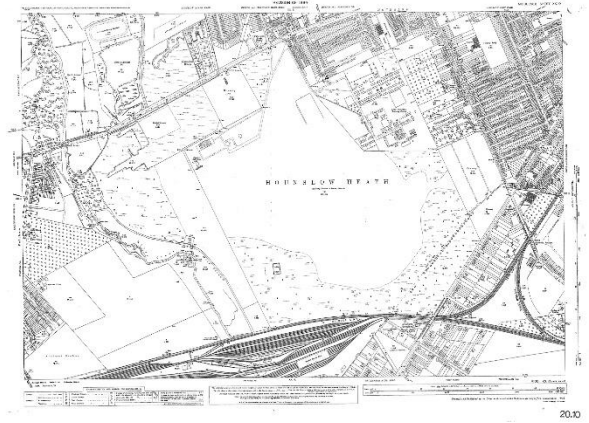

'connecting' track between Hereford and Boundaries Road 'which I used to walk as 'short cut' to De-Brome school' but now occupied by Houses; perhaps that is part of what Andy remembers.

(However on the accompanying map the track is shown clearly together with other significant features which should assist in checking what has been noted in my text)

The Chairman completed the evening with a Short talk on a personal (family) Remembrance (reflections) of WW1